

**PROJECT: 50138.3.31 TIP:W-5601AD**

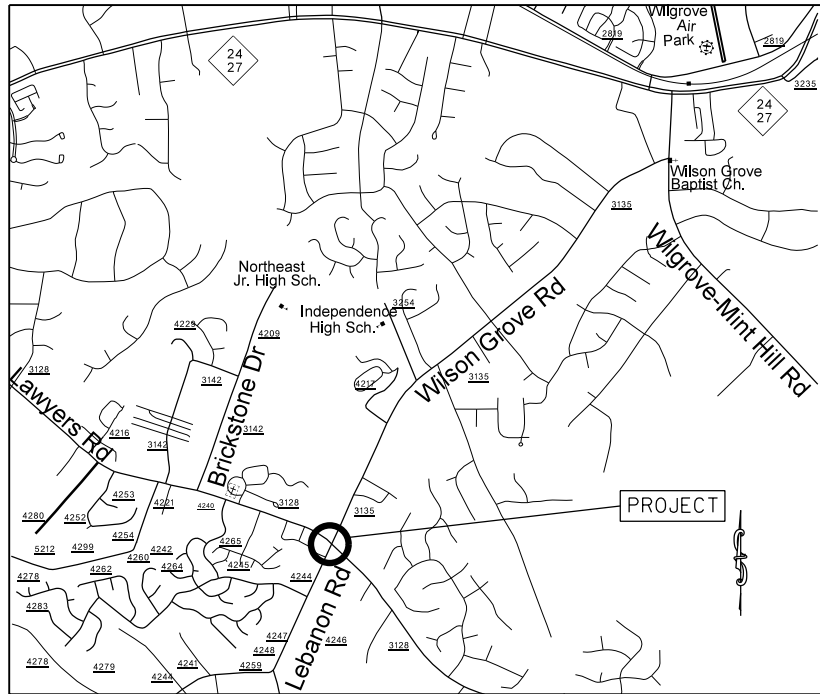

VICINITY MAP NOT TO SCALE

STATE OF NORTH CAROLINA  
DIVISION OF HIGHWAYS  
**MECKLENBURG COUNTY**

**LOCATION:** INTERSECTION OF LAWYERS ROAD (SR-3128) AT  
LEBANON ROAD (SR-3135) AND WILSON GROVE ROAD (SR-3135)

**TYPE OF WORK:** GRADING, PAVING, DRAINAGE, CONCRETE ISLAND,  
AND THERMOPLASTIC PAVEMENT MAKINGS

STATE	STATE PROJECT REFERENCE NO.	SHEET NO.	TOTAL SHEETS
N.C.	50138.3.31	1	
STATE PROJ. NO.	F.A. PROJ. NO.	DESCRIPTION	
50138.1.FD31	HSIP-3128(2)	P.E.	
50138.2.31	HSIP-3128(2)	RW	
50138.3.31	HSIP-3128(2)	CONST.	

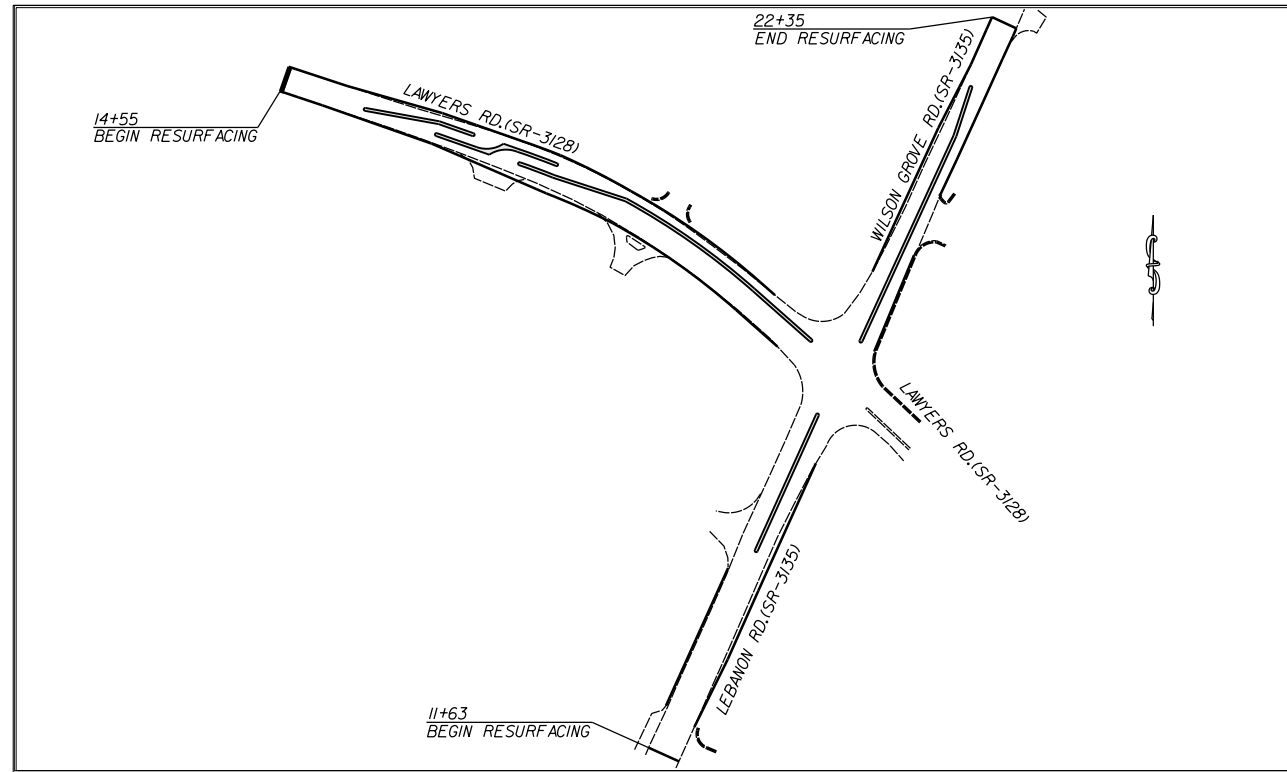

**GRAPHIC SCALES**

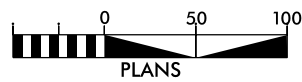

**DESIGN DATA**

ADT =  
ADT =  
DHV = %  
D = %  
T = %  
V = MPH

**PROJECT LENGTH**

LENGTH OF ROADWAY PROJECT 50138.3.31 = 0.36 MILES  
TOTAL LENGTH OF STATE PROJECT 50138.3.31 = 0.36 MILES

Prepared in the Office of:  
**DIVISION OF HIGHWAYS**  
DIVISION TEN  
DIVISION DESIGN / CONSTRUCT UNIT

RIGHT OF WAY DATE:

LETTING DATE:  
April 6, 2016

**RANDY BOWERS**  
PROJECT ENGINEER

**DONALD HARWARD**  
PROJECT DESIGN ENGINEER



DIVISION OF HIGHWAYS  
STATE OF NORTH CAROLINA

DocuSigned by:  
*Randy Bowers* 3/10/2016  
5044A66079864B2...  
APPROVED BY DDC ENGINEER DATE

STATE	PROJECT NO.	SHEET NO.	TOTAL SHEETS
N.C.	50138.331	2	
F.A. PROJECT NO.			

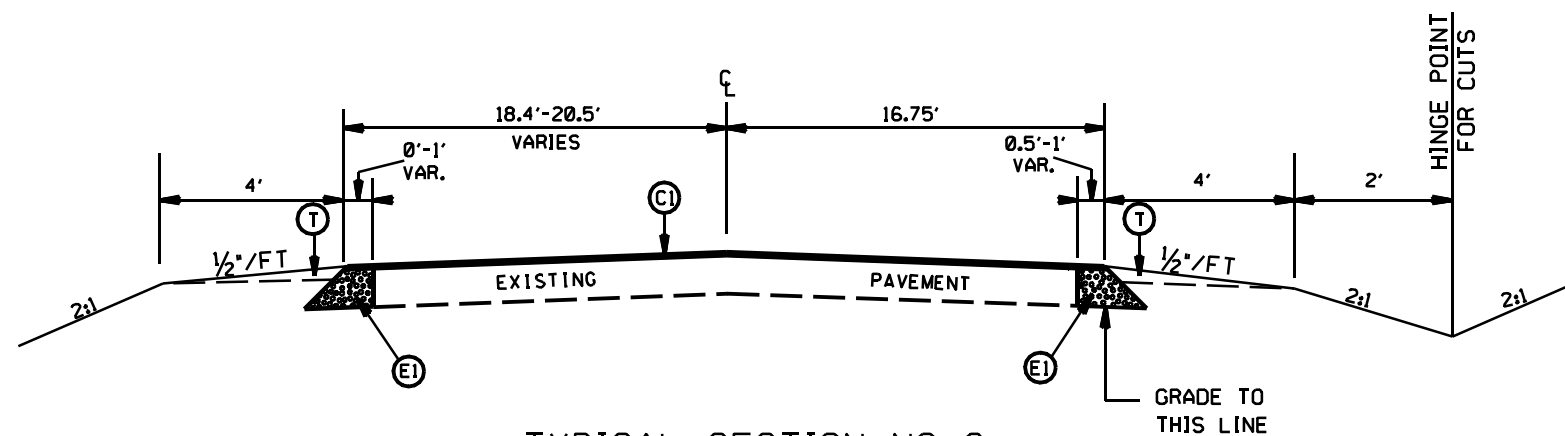

TYPICAL SECTION NO. 3  
STA. 15+36 TO 15+67 -L-

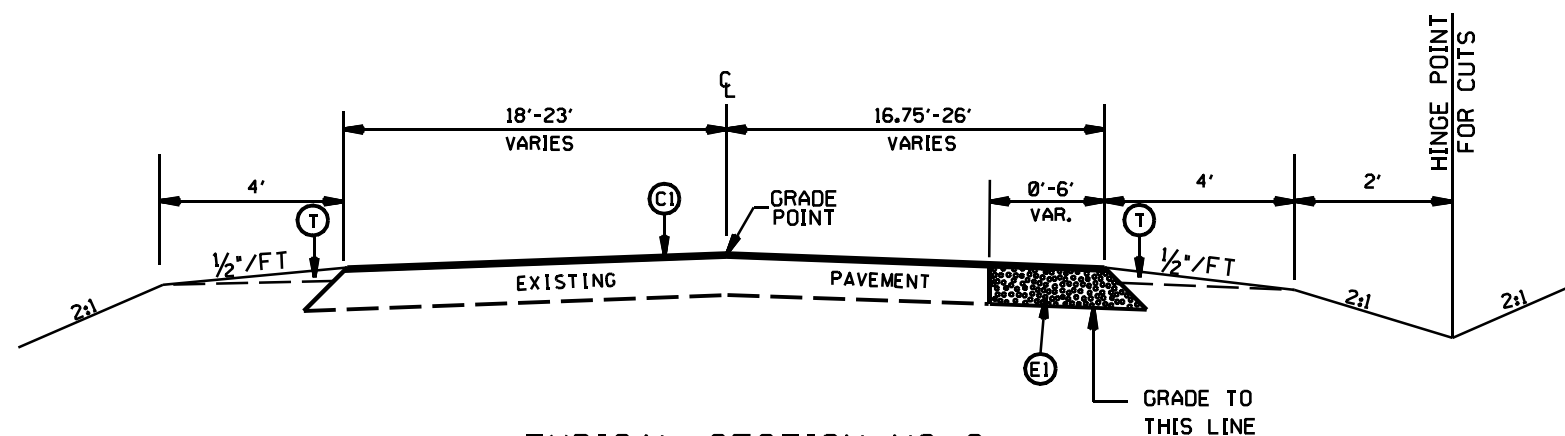

TYPICAL SECTION NO. 2  
STA. 15+14 TO 15+36 -L-  
STA. 12+13 TO 14+55 -Y-

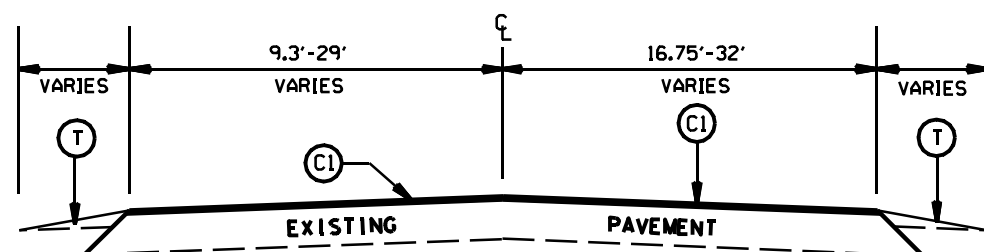

TYPICAL SECTION NO. 1  
STA. 14+55 TO 15+14 -L-  
STA. 22+44 TO 23+55 -L-  
STA. 11+63 TO 12+13 -Y-  
STA. 16+60 TO 16+87 -Y-  
STA. 21+66 TO 22+35 -Y-

PAVEMENT SCHEDULE

(C1)	PROP. APPROX. 1 1/2" ASPHALT CONC. SURFACE COURSE, TYPE S9.5C, AT AN AVERAGE RATE OF 168 LBS. PER SQ. YD.
(E1)	PROP. APPROX. 5" ASPHALT CONC. BASE COURSE, TYPE B25.0C, AT AN AVERAGE RATE OF 570 LBS. PER SQ. YD. IN EACH OF TWO LAYERS.
(R1)	PROP. 2'-6" CURB & GUTTER
(R4)	PROP. 5" MONOLITHIC ISLAND
(T)	EARTH MATERIAL

LEFT TURNS AND CONC. ISLANDS ON  
WILSON GROVE RD. (SR-3135), AND  
LAWYERS RD. (SR-3128), AND  
LEBANON RD. (SR-3135)

SCALE	N/A		REVISIONS
DATE	1-2016		
DWG. BY	DL5		
DESIGN BY	JDH		
APPROVED	RWB		

STATE	PROJECT NO.	SHEET NO.	TOTAL SHEETS
N.C.	50138.331	2A	
F.A. PROJECT NO.			

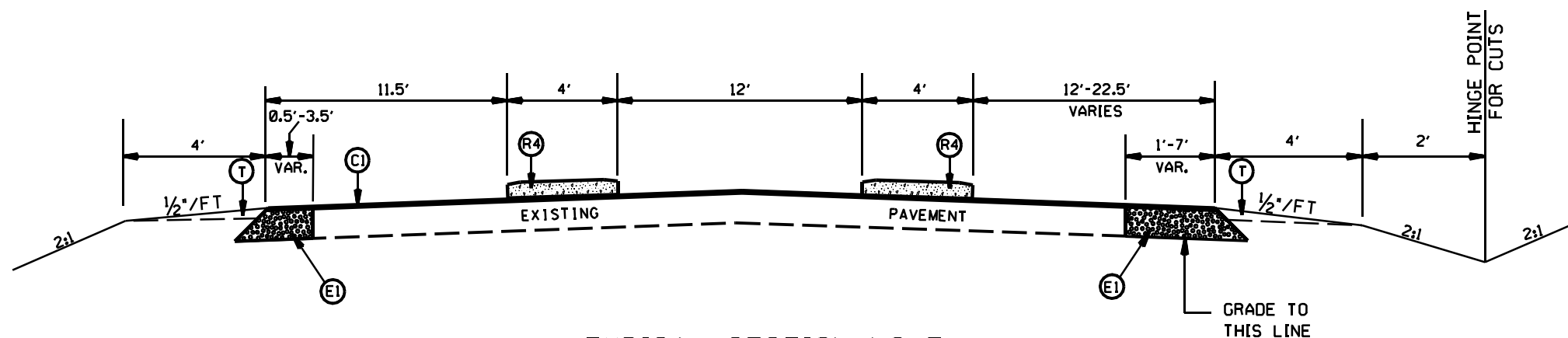

TYPICAL SECTION NO. 5  
 STA. 16+68 TO 17+18 -L-  
 STA. 17+85 TO 18+35 -L-

PAVEMENT SCHEDULE

(C1)	PROP. APPROX. 1 1/2" ASPHALT CONC. SURFACE COURSE, TYPE S9.5C, AT AN AVERAGE RATE OF 168 LBS. PER SQ. YD.
(E1)	PROP. APPROX. 5" ASPHALT CONC. BASE COURSE, TYPE B25.0C, AT AN AVERAGE RATE OF 570 LBS. PER SQ. YD. IN EACH OF TWO LAYERS.
(R1)	PROP. 2'-6" CURB & GUTTER
(R4)	PROP. 5" MONOLITHIC ISLAND
(T)	EARTH MATERIAL

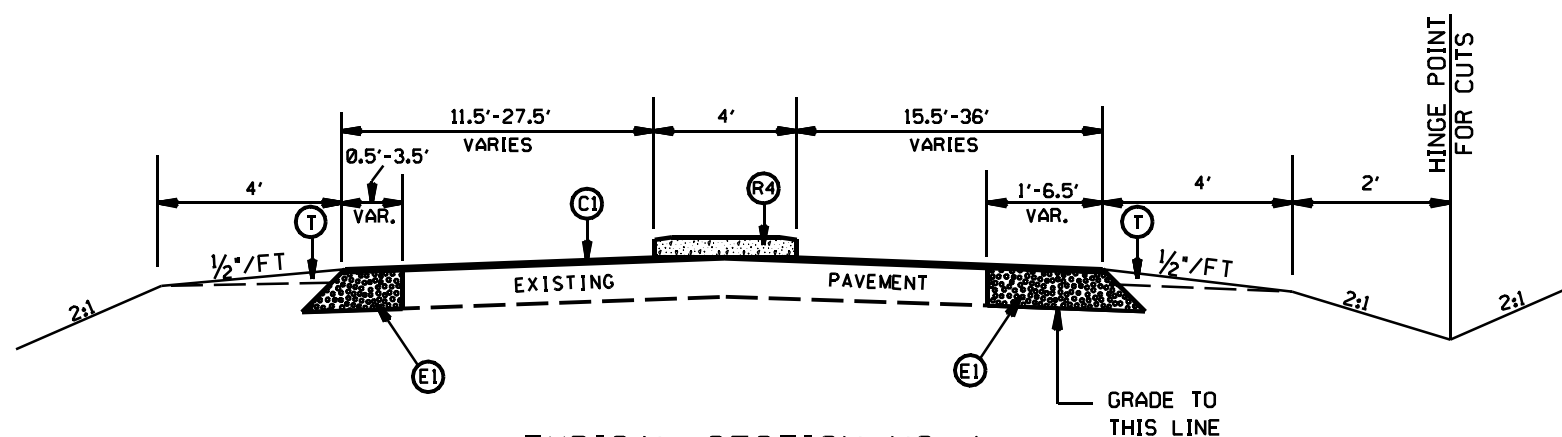

TYPICAL SECTION NO. 4  
 STA. 15+67 TO 16+68 -L-  
 STA. 17+18 TO 17+85 -L-  
 STA. 18+35 TO 21+66 -L-

LEFT TURNS AND CONC. ISLANDS ON  
 WILSON GROVE RD. (SR-3135), AND  
 LAWYERS RD. (SR-3128), AND  
 LEBANON RD. (SR-3135)

SCALE	N/A		REVISIONS
DATE	1-2016		
DWG. BY	DL5		
DESIGN BY	JDH		
APPROVED	RWB		

STATE	PROJECT NO.	SHEET NO.	TOTAL SHEETS
N.C.	50138.331	28	
F.A. PROJECT NO.			

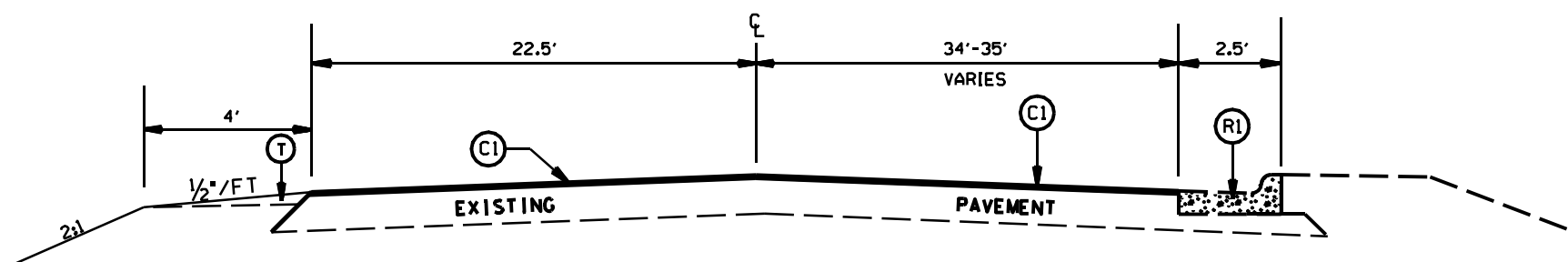

TYPICAL SECTION NO. 8  
STA. 17+48 TO 17+69 -Y-

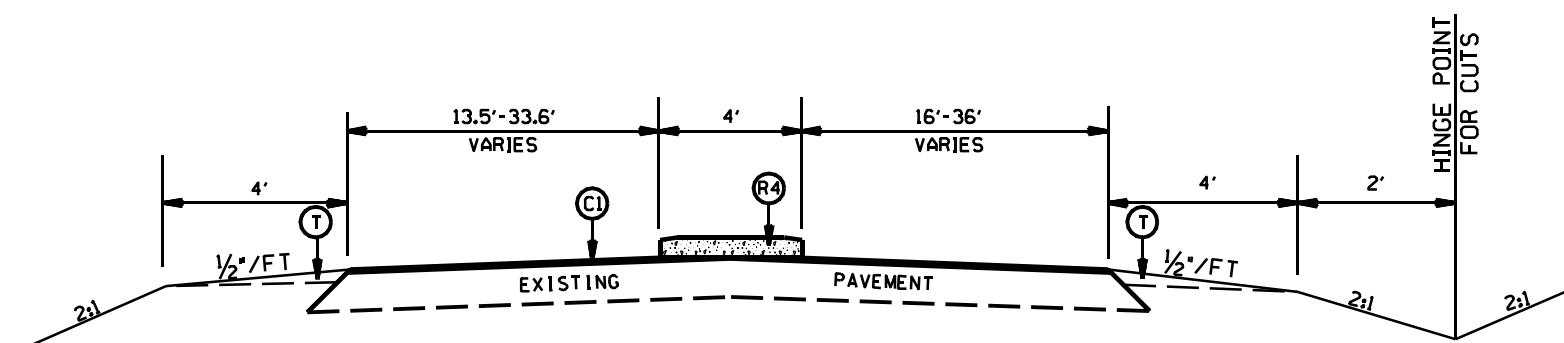

TYPICAL SECTION NO. 7  
STA. 22+14 TO 22+44 -L-  
STA. 15+98 TO 16+60 -Y-

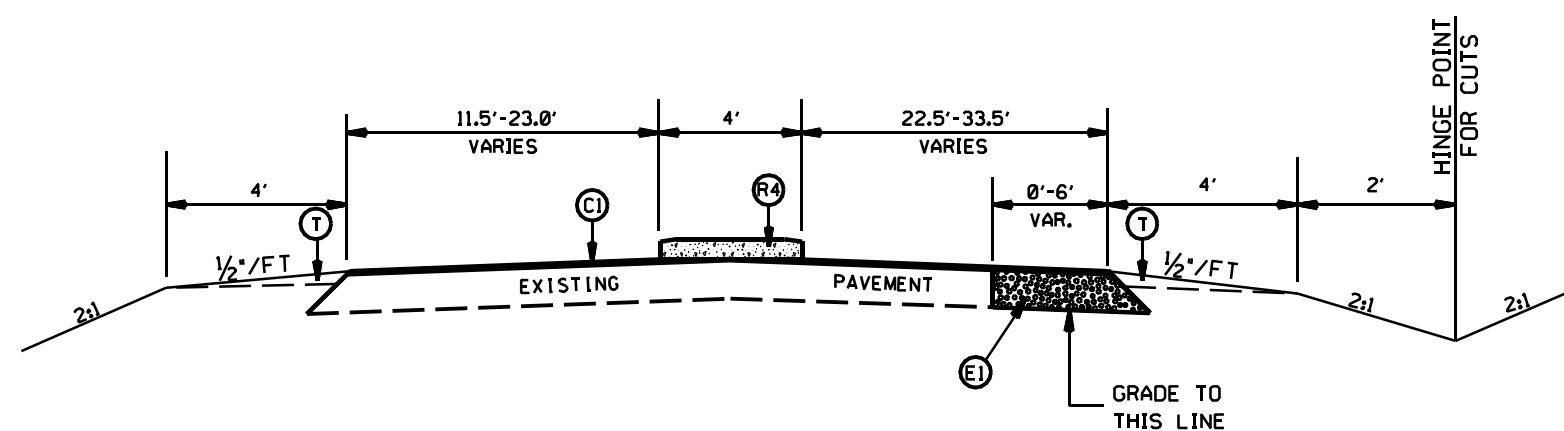

TYPICAL SECTION NO. 6  
STA. 21+66 TO 22+14 -L-  
STA. 14+55 TO 15+98 -Y-

PAVEMENT SCHEDULE

(C1)	PROP. APPROX. 1 1/2" ASPHALT CONC. SURFACE COURSE, TYPE S9.5C, AT AN AVERAGE RATE OF 168 LBS. PER SQ. YD.
(E1)	PROP. APPROX. 5" ASPHALT CONC. BASE COURSE, TYPE B25.0C, AT AN AVERAGE RATE OF 570 LBS. PER SQ. YD. IN EACH OF TWO LAYERS.
(R1)	PROP. 2'-6" CURB & GUTTER
(R4)	PROP. 5" MONOLITHIC ISLAND
(T)	EARTH MATERIAL

LEFT TURNS AND CONC. ISLANDS ON  
WILSON GROVE RD. (SR-3135), AND  
LAWYERS RD. (SR-3128), AND  
LEBANON RD. (SR-3135)

SCALE	N/A
DATE	1-2016
DWG. BY	DL5
DESIGN BY	JDH
APPROVED	RWB



REVISIONS	

STATE	PROJECT NO.	SHEET NO.	TOTAL SHEETS
N.C.	50138.331	20	
F.A. PROJECT NO.			

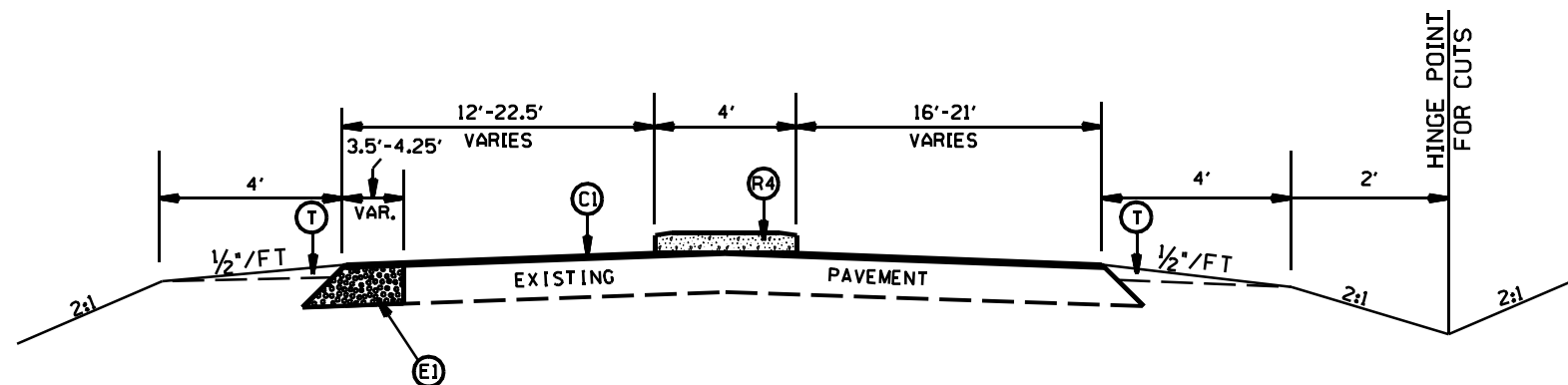

TYPICAL SECTION NO. 11  
STA. 19+35 TO 21+40 -Y-

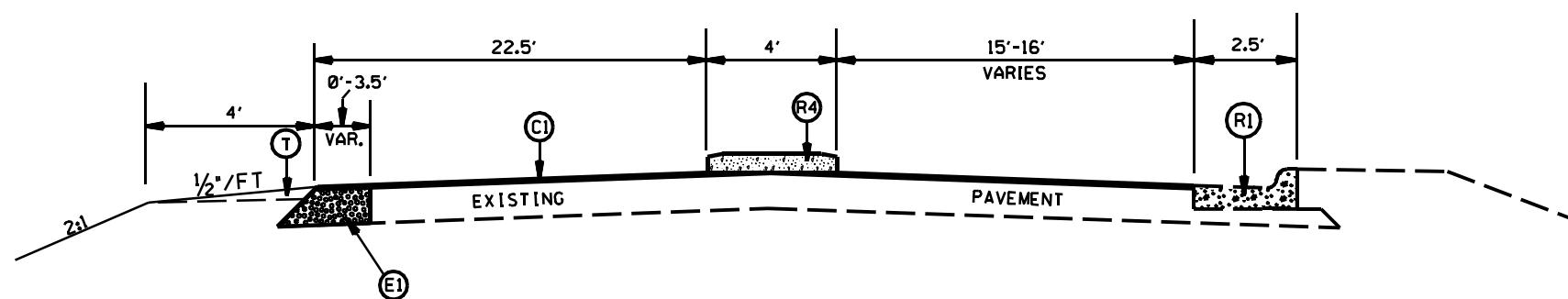

TYPICAL SECTION NO. 10  
STA. 18+61 TO 19+35 -Y-

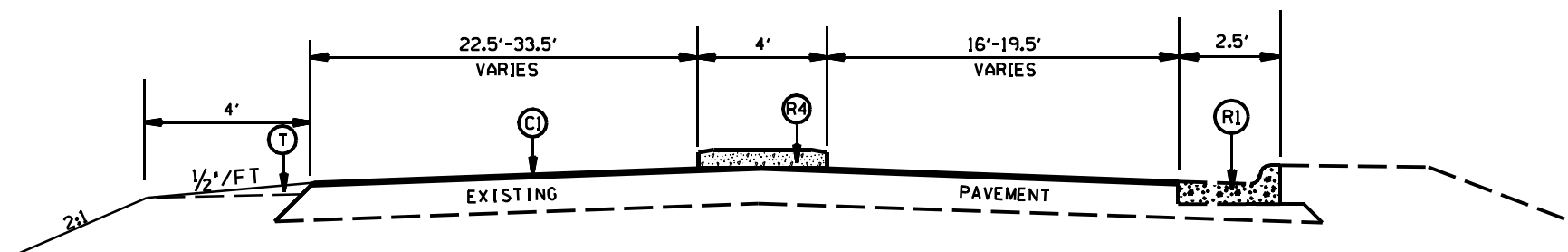

TYPICAL SECTION NO. 9  
STA. 17+69 TO 18+61 -Y-

PAVEMENT SCHEDULE

(C1)	PROP. APPROX. 1½" ASPHALT CONC. SURFACE COURSE, TYPE S9.5C, AT AN AVERAGE RATE OF 168 LBS. PER SQ. YD.
(E1)	PROP. APPROX. 5" ASPHALT CONC. BASE COURSE, TYPE B25.0C, AT AN AVERAGE RATE OF 570 LBS. PER SQ. YD. IN EACH OF TWO LAYERS.
(R1)	PROP. 2'-6" CURB & GUTTER
(R4)	PROP. 5" MONOLITHIC ISLAND
(T)	EARTH MATERIAL

LEFT TURNS AND CONC. ISLANDS ON  
WILSON GROVE RD. (SR-3135), AND  
LAWYERS RD. (SR-3128), AND  
LEBANON RD. (SR-3135)

SCALE	N/A
DATE	1-2016
DWG. BY	DL5
DESIGN BY	JDH
APPROVED	RWB



REVISIONS	

STATE	PROJECT NO.	SHEET NO.	TOTAL SHEETS
N.C.	50138.331	20	
F.A. PROJECT NO.			

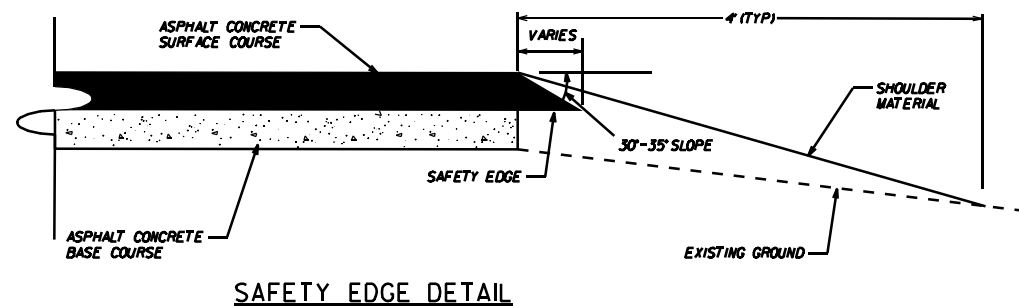

### PAVEMENT SCHEDULE

(C1)	PROP. APPROX. 1½" ASPHALT CONC. SURFACE COURSE, TYPE S9.5C, AT AN AVERAGE RATE OF 168 LBS. PER SQ. YD.
(E1)	PROP. APPROX. 5" ASPHALT CONC. BASE COURSE, TYPE B25.0C, AT AN AVERAGE RATE OF 570 LBS. PER SQ. YD. IN EACH OF TWO LAYERS.
(R1)	PROP. 2'-6" CURB & GUTTER
(R4)	PROP. 5" MONOLITHIC ISLAND
(T)	EARTH MATERIAL

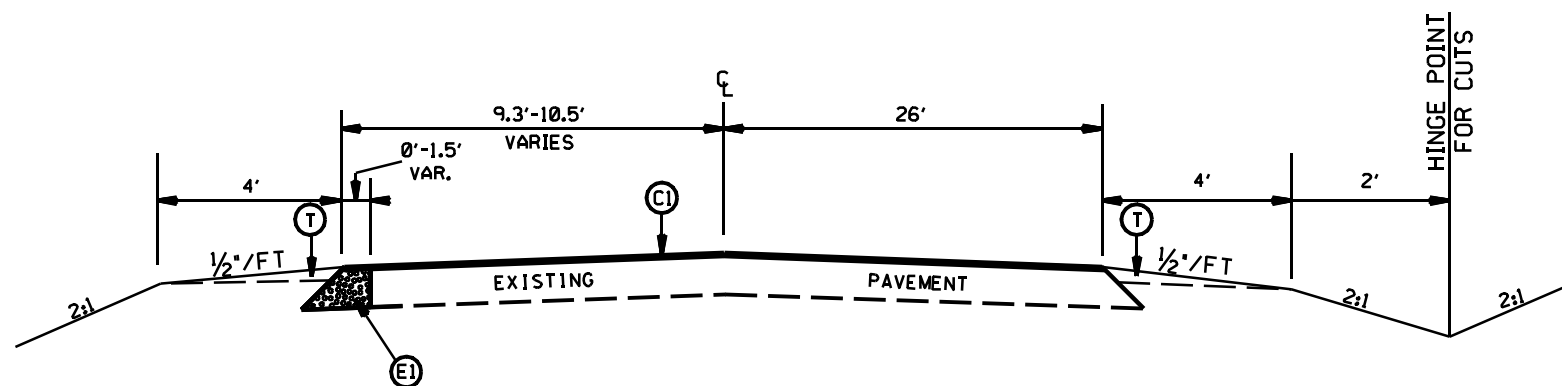

TYPICAL SECTION NO. 12  
STA. 21+40 TO 21+66 -Y-

LEFT TURNS AND CONC. ISLANDS ON  
WILSON GROVE RD. (SR-3135), AND  
LAWYERS RD. (SR-3128), AND  
LEBANON RD. (SR-3135)

SCALE	N/A		REVISIONS
DATE	1-2016		
DWG. BY	DL5		
DESIGN BY	JDH		
APPROVED	RWB		

STATE OF NORTH CAROLINA  
 DIVISION OF HIGHWAYS

NOTE: Invert Elevations are for Bid Purposes only and shall not be used for project construction stakeout.  
 See "Standard Specifications For Roads and Structures, Section 300-5".

LIST OF PIPES, ENDWALLS, ETC. (FOR PIPES 48" & UNDER)

STATION	LOCATION (L, RT, OR CL)	STRUCTURE NO.	TOP ELEVATION		INVERT ELEVATION	SLOPE CRITICAL	CLASS III R.C. PIPE (UNLESS NOTED OTHERWISE)								C.S. PIPE								CLASS III R.C. PIPE OR ALUMINIZED C.S. PIPE, TYPE IR OR HDPE PIPE, TYPE S OR D								ENDWALLS STD. 838.01, STD. 838.11 OR STD. 838.80 (UNLESS NOTED OTHERWISE)	QUANTITIES FOR DRAINAGE STRUCTURES * TOTAL LF. FOR PAY QUANTITY SHALL BE COL. "A" + (1.3 X COL. "B")	FRAME, GRATES AND HOOD STANDARD 840.03	TYPE OF GRATE			REMARKS		
			FROM	TO			12"	15"	18"	24"	30"	36"	42"	48"	12"	15"	18"	24"	30"	36"	42"	48"	12"	15"	18"	24"	30"	36"	42"	48"				E	F	G			
							THICKNESS OR GAUGE	PER EACH (0" THRU 5.0') 5.0' THRU 10.0' 10.0' AND ABOVE	A	B	R.C.P.	C.S.P.																											
15+75 -L-	CL	401	754.23	751.48																																			
		401	402	751.48	751.19	70																																	
16+48 -L-	LT	402	755.03	751.19																																			
		402	403	751.19	752.23	27																																	
16+75 -L-	CL	403	754.98	752.23																																			
		403	404	752.23	753.77	88																																	
17+65 -L-	LT	404	756.97	753.77																																			
		404	405	753.77	753.89	27																																	
17+90 -L-	CL	405	756.64	753.89																																			
17+97 -L-	RT	415	• 755.85	751.45	752.00																																		
		415	445	752.00	752.25	5																																	
17+97 -L-	RT	445	755.00	752.25																																			
19+28 -L-	LT	408	759.96	754.91																																			
		408	406	756.06	757.22	14																																	
19+45 -L-	LT	406	759.97	757.22																																			
		406	407	757.22	758.84	102																																	
20+50 -L-	LT	407	761.59	758.84																																			
16+72 -Y-	RT	424	764.33	759.58																																			
		424	410	759.58	762.06	14																																	
16+55 -Y-	RT	410	764.81	762.06																																			
		410	409	762.06	762.66	52																																	
16+00 -Y-	RT	409	765.41	762.66																																			
17+64 -Y-	RT	420	764.02	761.11																																			
		420	412	761.11	762.67	25																																	
17+75 -Y-	RT	412	765.42	762.67																																			

09-MAR-2016 15:51  
 S:\DCC\RDY\Mecklenburg\_Lowyers\_Lebanon\_Wilson\_Grove.sum\exgers\_Lebanon\_Wilson\_grove\_me5\_summary.dgn  
 2/25/16

STATE OF NORTH CAROLINA  
DIVISION OF HIGHWAYS

NOTE: Invert Elevations are for Bid Purposes only and shall not be used for project construction stakeout.  
See "Standard Specifications For Roads and Structures, Section 300-5".

LIST OF PIPES, ENDWALLS, ETC. (FOR PIPES 48" & UNDER)

Table with columns for Station, Location, Structure No., Top Elevation, Invert Elevation, Slope Critical, Pipe Size (12" to 48"), Pipe Material (Class III R.C. Pipe, C.S. Pipe, HDPE), Endwalls, Quantities, Frame/Grates, and Remarks. Includes a summary row for 'TOTALS'.

- ABBREVIATIONS
C.B. CATCH BASIN
N.D.I. NARROW DROP INLET
D.I. DROP INLET
G.D.I. GRATED DROP INLET
G.D.I. (N.S.) GRATED DROP INLET (NARROW SLOT)
J.B. JUNCTION BOX
M.H. MANHOLE
T.B.D.I. TRAFFIC BEARING DROP INLET
T.B.J.B. TRAFFIC BEARING JUNCTION BOX

09-MAR-2016 15:52 S:\DC\40Y\Mack\Lebanon\_Lowers\_Lebanon\_Wilson\_Grove\_sum\lebanon\_wilson\_grove\_me5\_summary.dgn



STATE	PROJECT NO.	SHEET NO.	TOTAL SHEETS
N.C.	50138.3.3i	4	
F.A. PROJECT NO.			

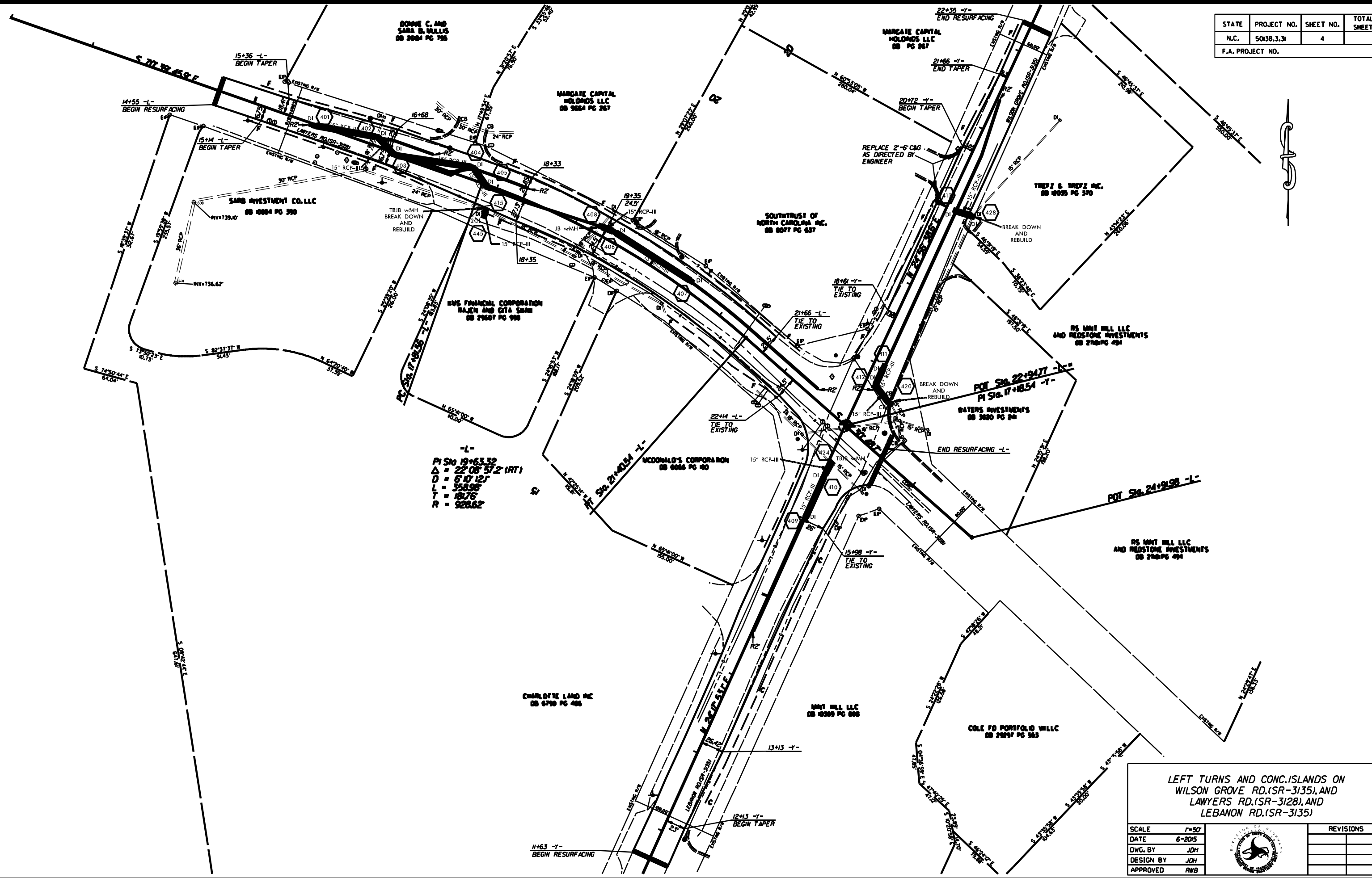

-L-  
 PI Sta 19+63.32  
 $\Delta = 22^{\circ} 08' 57.2" (RT)$   
 $D = 6' 10' 12"$   
 $L = 358.98'$   
 $T = 181.76'$   
 $R = 928.62'$

**LEFT TURNS AND CONC. ISLANDS ON  
 WILSON GROVE RD.(SR-3135), AND  
 LAWYERS RD.(SR-3128), AND  
 LEBANON RD.(SR-3135)**

SCALE	1"=50'		REVISIONS
DATE	6-2015		
DWG. BY	JDH		
DESIGN BY	JDH		
APPROVED	RWB		

STATE	STATE PROJECT REFERENCE NO.	SHEET NO.	TOTAL SHEETS
N.C.	W-5601AD	EC-1	
STATE PROJ. NO.	F.A. PROJ. NO.	DESCRIPTION	

STATE OF NORTH CAROLINA  
 DIVISION OF HIGHWAYS  
 PLAN FOR PROPOSED  
 HIGHWAY EROSION CONTROL

PROJECT: 50138.3.31 TIP: W-5601AD

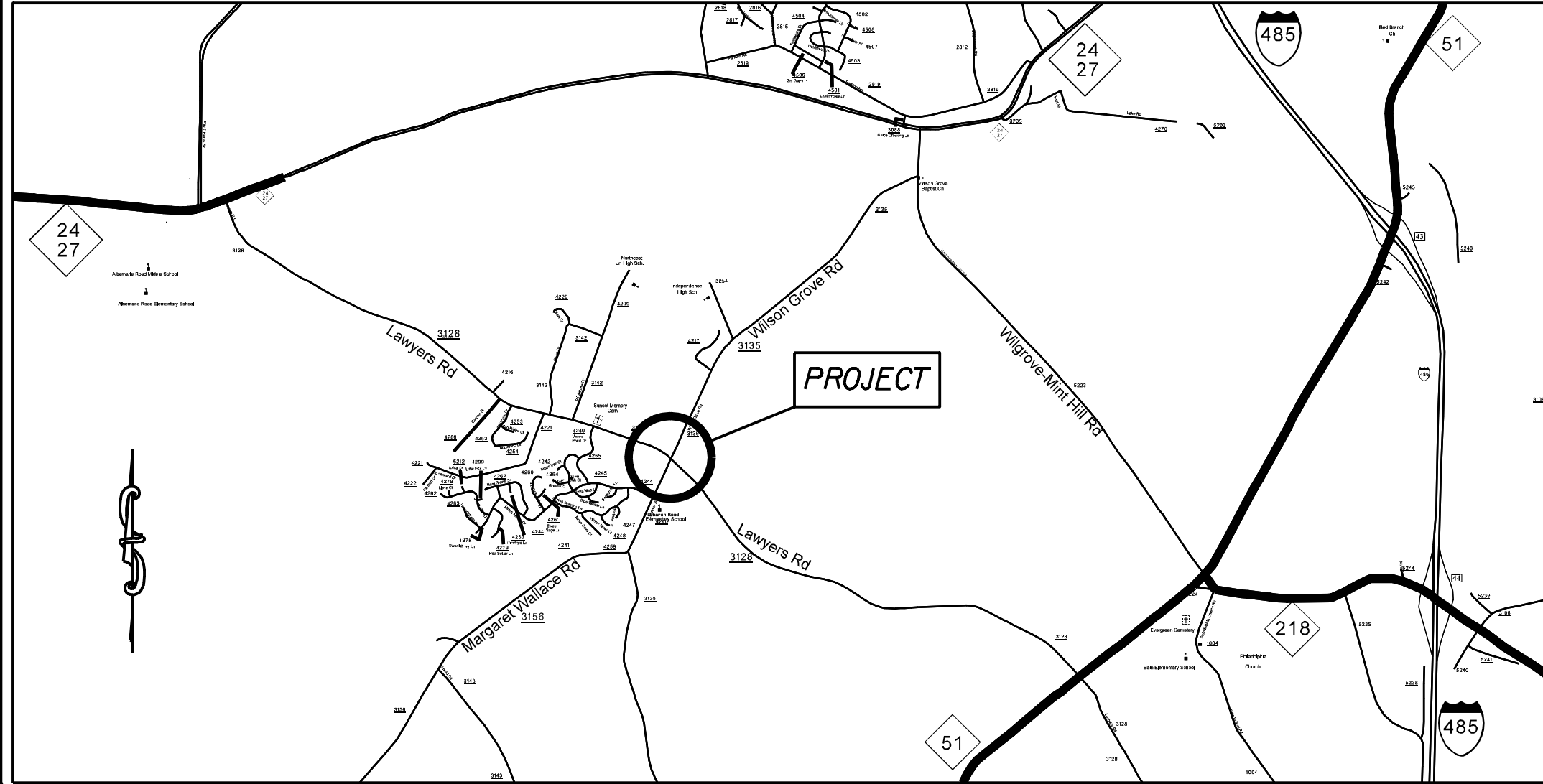

**EROSION AND SEDIMENT CONTROL MEASURES**

Sub.	Description	Symbol
1630.05	Temporary Silt Ditch	— TP —
1630.06	Temporary Diversion	— TD —
1606.01	Temporary Silt Fence	— SF —
1606.01	Special Sediment Control Fence	— SCF —
1622.01	Temporary Berms and Slope Drains	— TBSD —
1630.02	Silt Basin Type B	— SB —
1633.01	Temporary Rock Silt Check Type-A	— TRSCA —
	Temporary Rock Silt Check Type-A with Matting and Polyacrylamide (PAM)	— TRSCA/PAM —
1633.02	Temporary Rock Silt Check Type-B	— TRSCB —
	Wattle / Coir Fiber Wattle	— W —
	Wattle / Coir Fiber Wattle with Polyacrylamide (PAM)	— W/PAM —
1634.01	Temporary Rock Sediment Dam Type-A	— TRSDA —
1634.02	Temporary Rock Sediment Dam Type-B	— TRSDB —
1635.01	Rock Pipe Inlet Sediment Trap Type-A	— RPISDA —
1635.02	Rock Pipe Inlet Sediment Trap Type-B	— RPISDB —
1630.04	Stilling Basin	— SB —
1630.06	Special Stilling Basin	— SSB —
	Rock Inlet Sediment Trap:	
1632.01	Type A	— RISA —
1632.02	Type B	— RISB —
1632.03	Type C	— RISC —
	Skimmer Basin	— SKB —
	Tiered Skimmer Basin	— TSKB —
	Infiltration Basin	— IB —

THIS PROJECT CONTAINS  
 EROSION CONTROL PLANS  
 FOR CLEARING AND  
 GRUBBING PHASE OF  
 CONSTRUCTION.

**GRAPHIC SCALE**

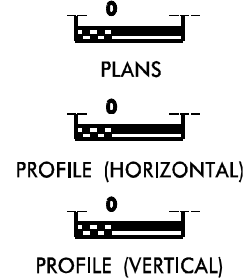

ROADSIDE ENVIRONMENTAL UNIT  
 DIVISION OF HIGHWAYS  
 STATE OF NORTH CAROLINA

THESE EROSION AND SEDIMENT CONTROL PLANS COMPLY  
 WITH THE REGULATIONS SET FORTH BY THE  
 NCG-010000 GENERAL CONSTRUCTION PERMIT EFFECTIVE AUGUST 3, 2011  
 ISSUED BY THE NORTH CAROLINA DEPARTMENT OF ENVIRONMENT AND  
 NATURAL RESOURCES DIVISION OF WATER QUALITY.

Prepared in the Office of:  
**DDC UNIT DIVISION 10**  
 DEPARTMENT OF TRANSPORTATION  
 DIVISION OF HIGHWAYS  
**2012 STANDARD SPECIFICATIONS**  
 DONALD HARWARD 3028  
 EROSION CONTROL DESIGNER LEVEL III-A CERTIFICATION #

Roadway Standard Drawings

The following roadway english standards as appear in "Roadway Standard Drawings"— Roadway Design Unit - N. C. Department of Transportation - Raleigh, N. C., dated January 2012 and the latest revision thereto are applicable to this project and by reference hereby are considered a part of these plans.

1604.01 Railroad Erosion Control Detail	1632.01 Rock Inlet Sediment Trap Type A
1605.01 Temporary Silt Fence	1632.02 Rock Inlet Sediment Trap Type B
1606.01 Special Sediment Control Fence	1632.03 Rock Inlet Sediment Trap Type C
1607.01 Gravel Construction Entrance	1633.01 Temporary Rock Silt Check Type A
1622.01 Temporary Berms and Slope Drains	1633.02 Temporary Rock Silt Check Type B
1630.01 Riser Basin	1634.01 Temporary Rock Sediment Dam Type A
1630.02 Silt Basin Type B	1634.02 Temporary Rock Sediment Dam Type B
1630.03 Temporary Silt Ditch	1635.01 Rock Pipe Inlet Sediment Trap Type A
1630.04 Stilling Basin	1635.02 Rock Pipe Inlet Sediment Trap Type B
1630.05 Temporary Diversion	1640.01 Coir Fiber Baffle
1630.06 Special Stilling Basin	1645.01 Temporary Stream Crossing
1631.01 Matting Installation	

STATE	PROJECT NO.	SHEET NO.	TOTAL SHEETS
N.C.	50138.3.31	EC-2	
F.A. PROJECT NO.			

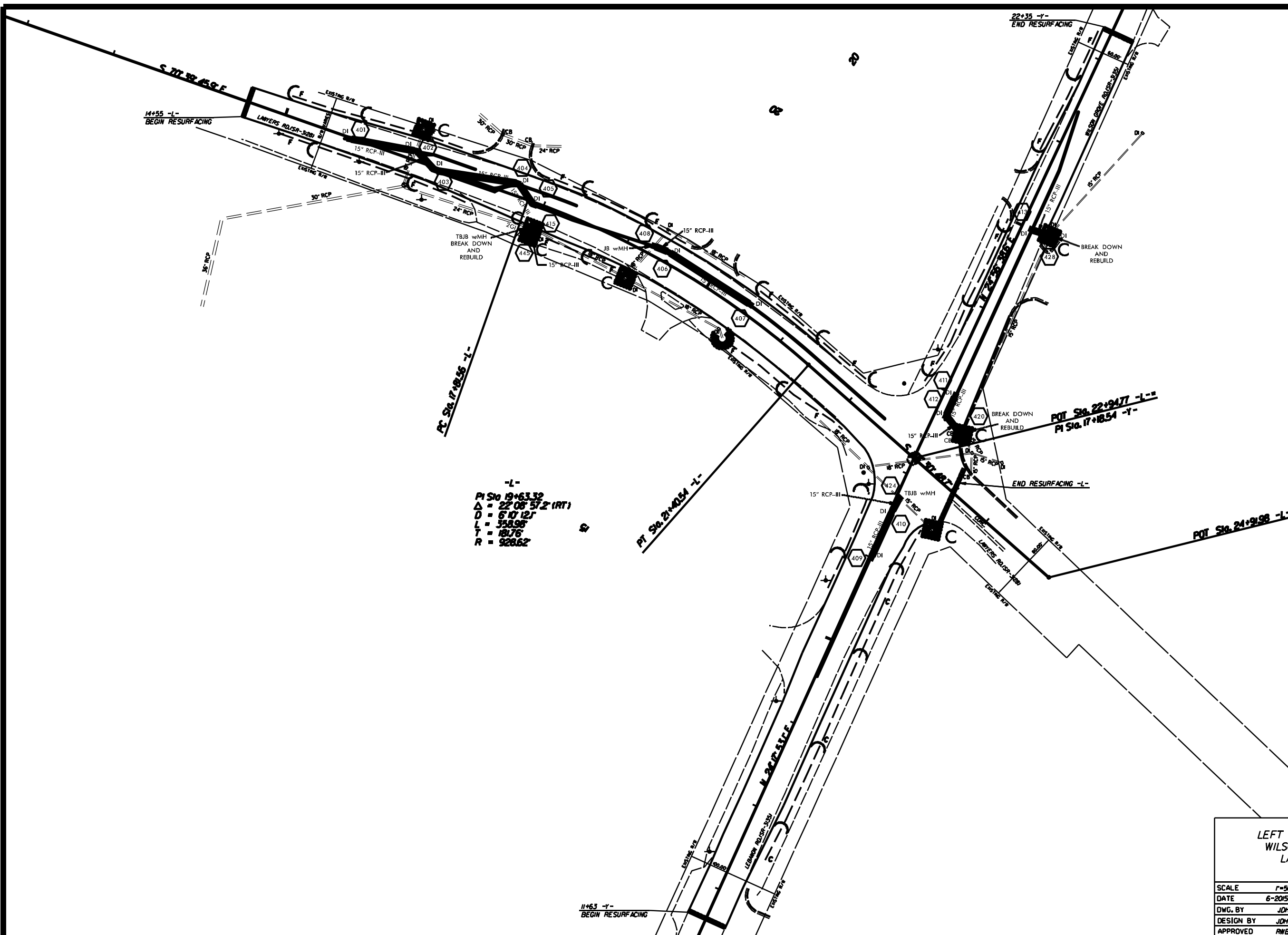

-L-  
PI Sta 19+63.32  
Δ = 22° 08' 57.2" (RT)  
D = 6' 10" 12"  
L = 358.98'  
T = 181.76'  
R = 928.62'

**LEFT TURNS AND CONC. ISLANDS ON  
WILSON GROVE RD.(SR-3135), AND  
LAWYERS RD.(SR-3128), AND  
LEBANON RD.(SR-3135)**

SCALE	1"=50'		REVISIONS
DATE	6-2015		
DWG. BY	JDH		
DESIGN BY	JDH		
APPROVED	RWB		

STATE	PROJECT NO.	SHEET NO.	TOTAL SHEETS
N.C.	50138.3.31	PMP-1	
F.A. PROJECT NO.			

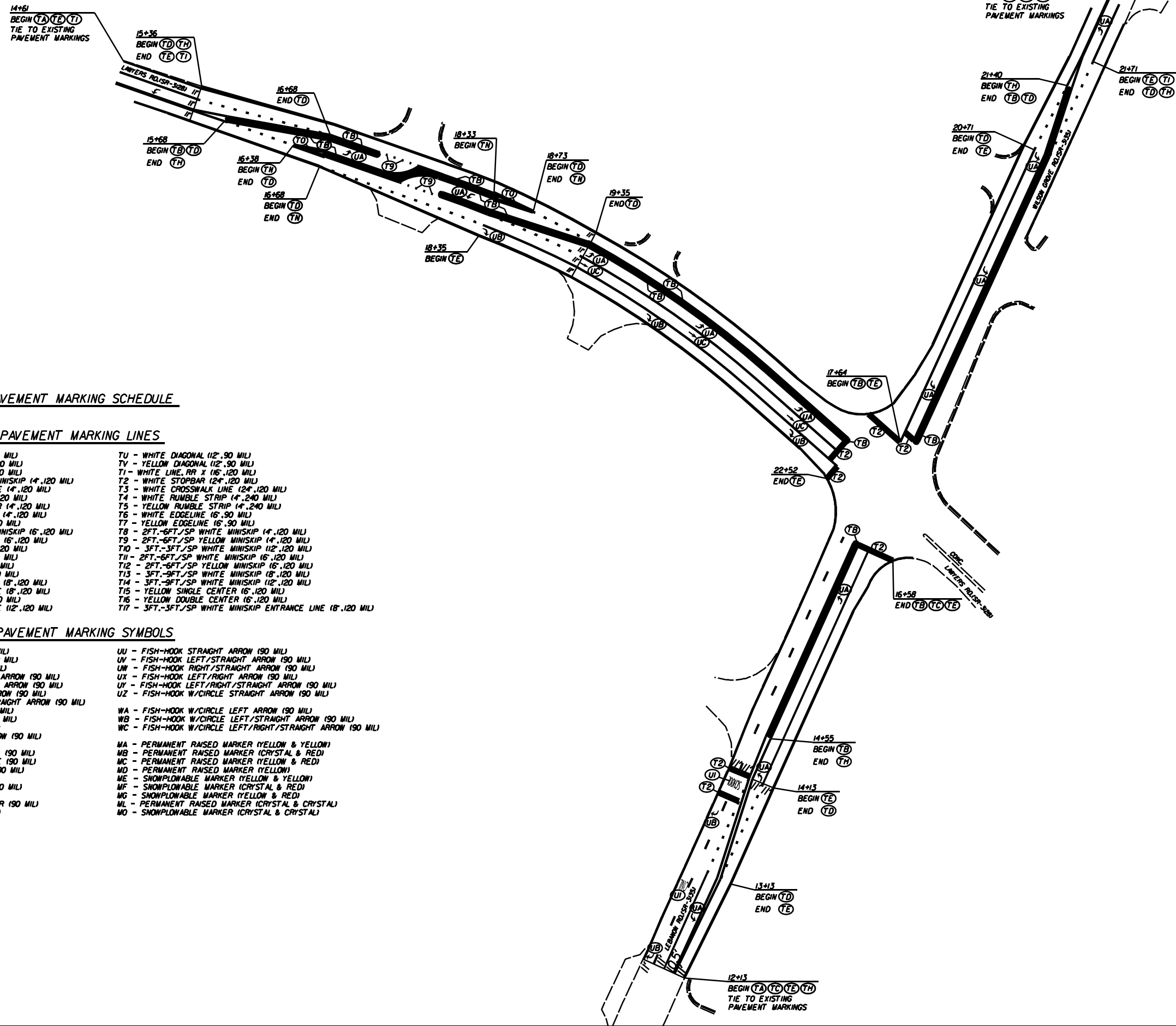

**PAVEMENT MARKING SCHEDULE**

**PAVEMENT MARKING LINES**

- |   |   |
|---|---|
| TA - WHITE EDGELINE (4'.90 MIL)               | TU - WHITE DIAGONAL (12'.90 MIL)                              |
| TB - YELLOW EDGELINE (4'.90 MIL)              | TV - YELLOW DIAGONAL (12'.90 MIL)                             |
| TC - 10FT. WHITE SKIP (4'.120 MIL)            | TW - WHITE LINE, RR X (16'.120 MIL)                           |
| TD - 3FT.-9FT./SP WHITE MINISKIP (4'.120 MIL) | TX - WHITE STOPBAR (24'.120 MIL)                              |
| TE - WHITE SOLID LANE LINE (4'.120 MIL)       | T3 - WHITE CROSSWALK LINE (24'.120 MIL)                       |
| TF - 10FT. YELLOW SKIP (4'.120 MIL)           | T4 - WHITE RUMBLE STRIP (4'.240 MIL)                          |
| TH - YELLOW SINGLE CENTER (4'.120 MIL)        | T5 - YELLOW RUMBLE STRIP (4'.240 MIL)                         |
| TI - YELLOW DOUBLE CENTER (4'.120 MIL)        | T6 - WHITE EDGELINE (6'.90 MIL)                               |
| TJ - 10FT. WHITE SKIP (6'.120 MIL)            | T7 - YELLOW EDGELINE (6'.90 MIL)                              |
| TK - 3FT.-9FT./SP WHITE MINISKIP (6'.120 MIL) | T8 - 2FT.-6FT./SP WHITE MINISKIP (4'.120 MIL)                 |
| TL - WHITE SOLID LANE LINE (6'.120 MIL)       | T9 - 2FT.-6FT./SP YELLOW MINISKIP (4'.120 MIL)                |
| TM - 10FT. YELLOW SKIP (6'.120 MIL)           | T10 - 3FT.-3FT./SP WHITE MINISKIP (12'.120 MIL)               |
| TN - WHITE GORELINE (18'.90 MIL)              | T11 - 2FT.-6FT./SP WHITE MINISKIP (6'.120 MIL)                |
| TO - WHITE DIAGONAL (18'.90 MIL)              | T12 - 2FT.-6FT./SP YELLOW MINISKIP (6'.120 MIL)               |
| TP - YELLOW DIAGONAL (18'.90 MIL)             | T13 - 3FT.-9FT./SP WHITE MINISKIP (18'.120 MIL)               |
| TQ - WHITE CROSSWALK LINE (18'.120 MIL)       | T14 - 3FT.-9FT./SP WHITE MINISKIP (12'.120 MIL)               |
| TR - WHITE SOLID LANE LINE (18'.120 MIL)      | T15 - YELLOW SINGLE CENTER (16'.120 MIL)                      |
| TS - WHITE GORELINE (12'.90 MIL)              | T16 - YELLOW DOUBLE CENTER (16'.120 MIL)                      |
| TT - WHITE SOLID LANE LINE (12'.120 MIL)      | T17 - 3FT.-3FT./SP WHITE MINISKIP ENTRANCE LINE (18'.120 MIL) |

**PAVEMENT MARKING SYMBOLS**

- |  |  |
|--|--|
| UA - LEFT TURN ARROW (90 MIL)                  | UU - FISH-HOOK STRAIGHT ARROW (90 MIL)                     |
| UB - RIGHT TURN ARROW (90 MIL)                 | UV - FISH-HOOK LEFT/STRAIGHT ARROW (90 MIL)                |
| UC - STRAIGHT ARROW (90 MIL)                   | UN - FISH-HOOK RIGHT/STRAIGHT ARROW (90 MIL)               |
| UD - COMBO. LEFT/STRAIGHT ARROW (90 MIL)       | UX - FISH-HOOK LEFT/RIGHT ARROW (90 MIL)                   |
| UE - COMBO. RIGHT/STRAIGHT ARROW (90 MIL)      | UY - FISH-HOOK LEFT/RIGHT/STRAIGHT ARROW (90 MIL)          |
| UF - COMBO. LEFT/RIGHT ARROW (90 MIL)          | UZ - FISH-HOOK W/CIRCLE STRAIGHT ARROW (90 MIL)            |
| UG - COMBO. LEFT/RIGHT/STRAIGHT ARROW (90 MIL) |  |
| UH - HANDICAP PARKING (90 MIL)                 | VA - FISH-HOOK W/CIRCLE LEFT ARROW (90 MIL)                |
| UI - ALPHANUMERIC CHAR. (120 MIL)              | VB - FISH-HOOK W/CIRCLE LEFT/STRAIGHT ARROW (90 MIL)       |
| UJ - BICYCLE SYMBOL (90 MIL)                   | VC - FISH-HOOK W/CIRCLE LEFT/RIGHT/STRAIGHT ARROW (90 MIL) |
| UK - BICYCLE STRAIGHT ARROW (90 MIL)           |  |
| UL - BICYCLE CHAR. (120 MIL)                   | VA - PERMANENT RAISED MARKER (YELLOW & YELLOW)             |
| UM - 12" YIELD LINE TRIANGLE (90 MIL)          | VB - PERMANENT RAISED MARKER (CRYSTAL & RED)               |
| UN - 24" YIELD LINE TRIANGLE (90 MIL)          | VC - PERMANENT RAISED MARKER (YELLOW & RED)                |
| UO - BICYCLE LEFT ARROW (90 MIL)               | VD - PERMANENT RAISED MARKER (YELLOW)                      |
| UP - MERGE ARROW (90 MIL)                      | VE - SNOWPLOWABLE MARKER (YELLOW & YELLOW)                 |
| UR - RAMP ARROW SYMBOL (90 MIL)                | VF - SNOWPLOWABLE MARKER (CRYSTAL & RED)                   |
| US - SHARROW (90 MIL)                          | VG - SNOWPLOWABLE MARKER (YELLOW & RED)                    |
| UT - BICYCLE LOOP DETECTOR (90 MIL)            | VL - PERMANENT RAISED MARKER (CRYSTAL & CRYSTAL)           |
| UU - U-TURN ARROW (90 MIL)                     | VM - SNOWPLOWABLE MARKER (CRYSTAL & CRYSTAL)               |

**LEFT TURNS AND CONC. ISLANDS ON  
WILSON GROVE RD. (SR-3135), AND  
LAWYERS RD. (SR-3128), AND  
LEBANON RD. (SR-3135)**

SCALE	1"=50'		REVISIONS
DATE	1-2016		
DWG. BY	JDH		
DESIGN BY	JDH		
APPROVED	RWB		

75 70 65 60 55 50 45 40 35 30 25 20 15 10 5 0 5 10 15 20 25 30 35 40 45 50 55 60 65 70 75

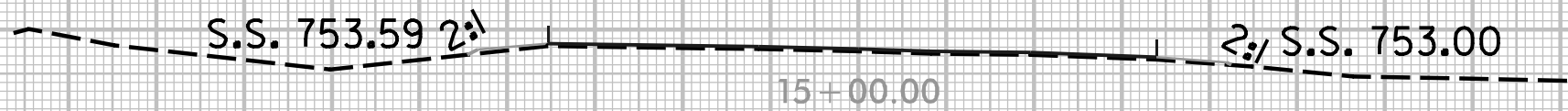
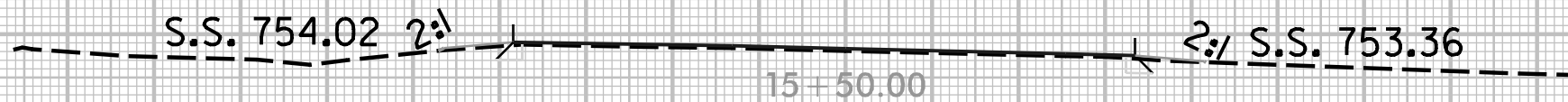
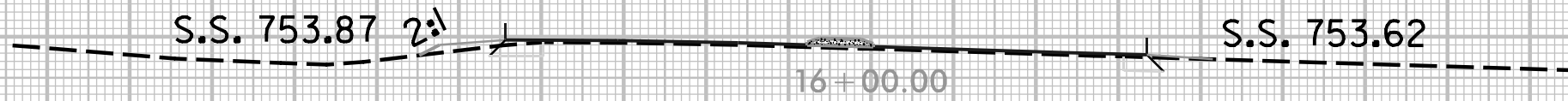
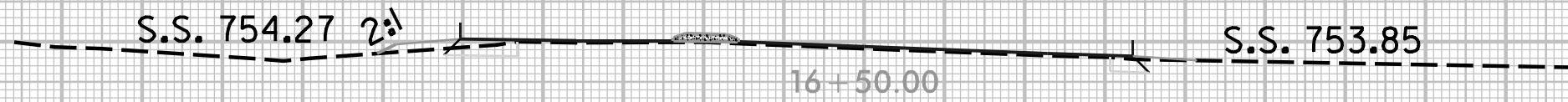

75 70 65 60 55 50 45 40 35 30 25 20 15 10 5 0 5 10 15 20 25 30 35 40 45 50 55 60 65 70 75

75 70 65 60 55 50 45 40 35 30 25 20 15 10 5 0 5 10 15 20 25 30 35 40 45 50 55 60 65 70 75

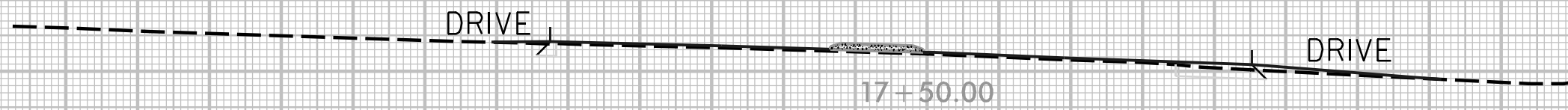
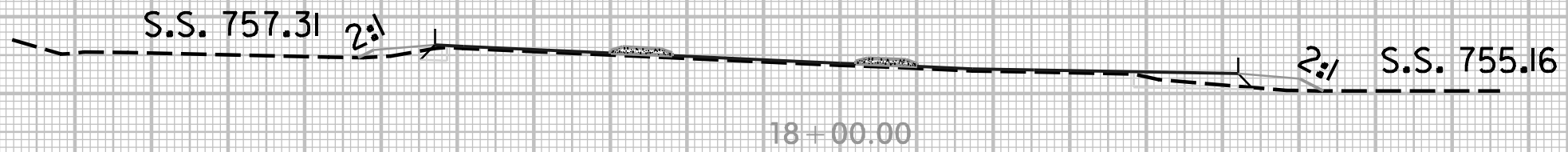
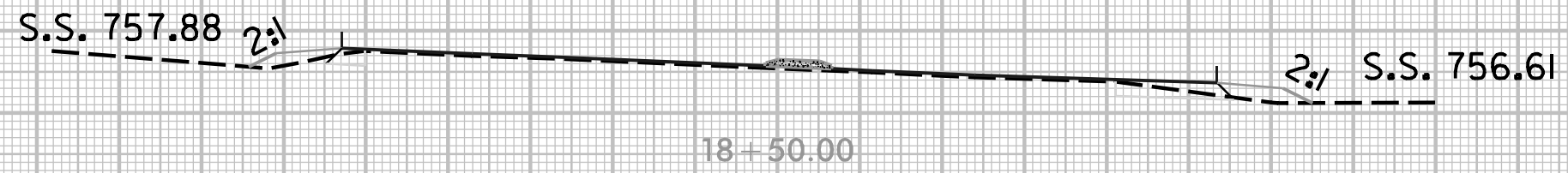
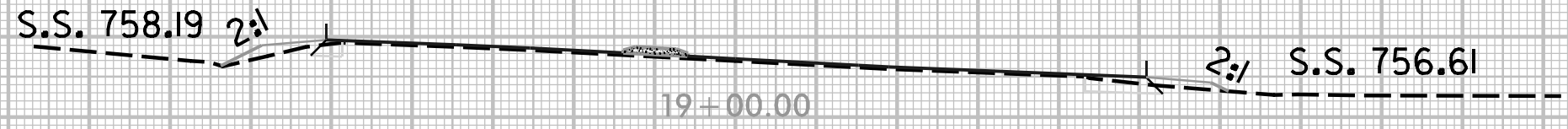

75 70 65 60 55 50 45 40 35 30 25 20 15 10 5 0 5 10 15 20 25 30 35 40 45 50 55 60 65 70 75

8/23/99  
C  
U  
S  
T  
O  
M  
E  
R  
S  
O  
N  
L  
Y  
P  
L  
E  
A  
S  
E  
D  
O  
N  
T  
R  
E  
S  
S  
A  
N  
D  
D  
I  
S  
S  
E  
M  
I  
N  
A  
T  
E  
T  
H  
I  
S  
D  
R  
A  
W  
I  
N  
G  
O  
R  
A  
N  
Y  
P  
A  
R  
T  
S  
T  
H  
E  
R  
E  
O  
N  
A  
N  
Y  
O  
T  
H  
E  
R  
M  
E  
D  
I  
A  
S  
O  
F  
T  
W  
A  
R  
E  
P  
L  
E  
A  
S  
E  
C  
O  
N  
T  
A  
C  
T  
T  
H  
E  
A  
U  
T  
H  
O  
R  
I  
T  
Y  
O  
F  
T  
H  
I  
S  
D  
R  
A  
W  
I  
N  
G  
O  
R  
A  
N  
Y  
P  
A  
R  
T  
S  
T  
H  
E  
R  
E  
O  
N  
A  
N  
Y  
O  
T  
H  
E  
R  
M  
E  
D  
I  
A  
S  
O  
F  
T  
W  
A  
R  
E  
P  
L  
E  
A  
S  
E  
C  
O  
N  
T  
A  
C  
T  
T  
H  
E  
A  
U  
T  
H  
O  
R  
I  
T  
Y  
O  
F  
T  
H  
I  
S  
D  
R  
A  
W  
I  
N  
G

8/23/99



PROJ REFERENCE NO:  
50138-3-31

SHEET NO:  
X-5

75 70 65 60 55 50 45 40 35 30 25 20 15 10 5 0 5 10 15 20 25 30 35 40 45 50 55 60 65 70 75

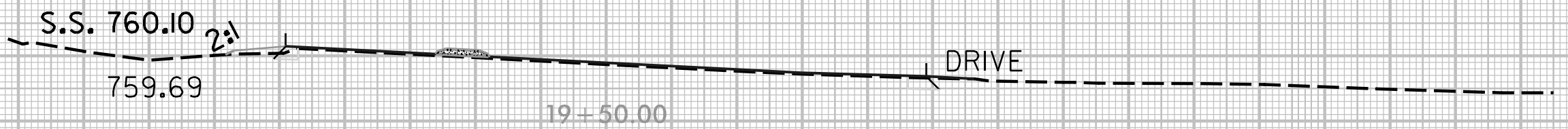
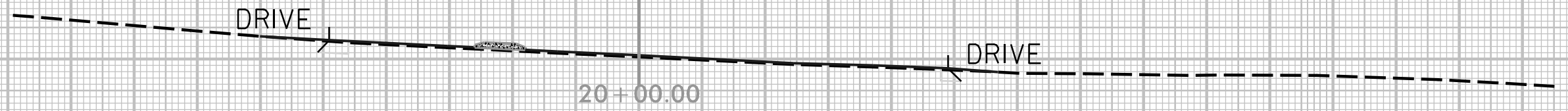
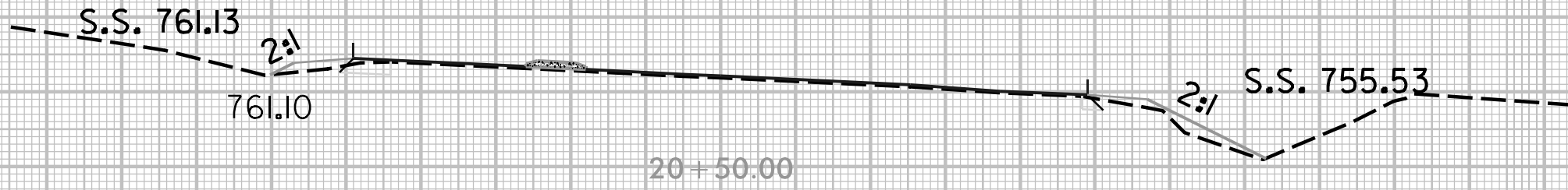
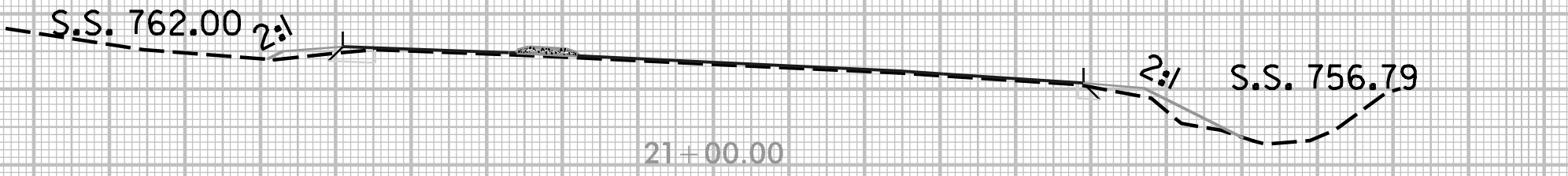

75 70 65 60 55 50 45 40 35 30 25 20 15 10 5 0 5 10 15 20 25 30 35 40 45 50 55 60 65 70 75

CUSTOMER'S PROPERTY  
NO PART OF THIS PLAN  
IS TO BE CONSIDERED  
AS A GUARANTEE OF  
FITNESS OR ACCURACY  
UNLESS OTHERWISE  
SPECIFIED

8/23/99



PROJ. REFERENCE NO.  
50138-3-31

SHEET NO.  
X-4

75 70 65 60 55 50 45 40 35 30 25 20 15 10 5 0 5 10 15 20 25 30 35 40 45 50 55 60 65 70 75

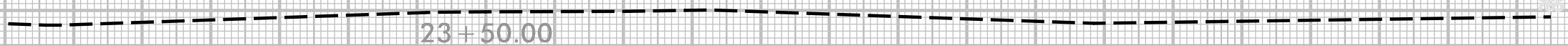

23 + 50.00



23 + 00.00

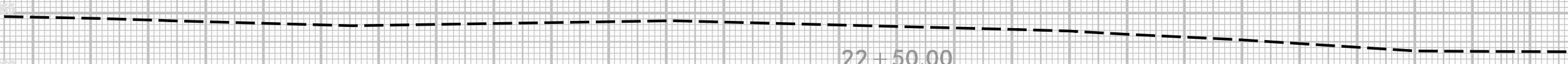

22 + 50.00

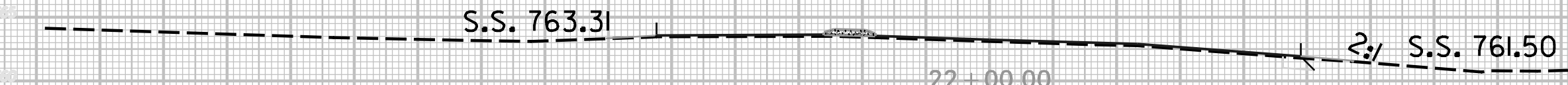

S.S. 763.31

22 + 00.00

2:1 S.S. 761.50

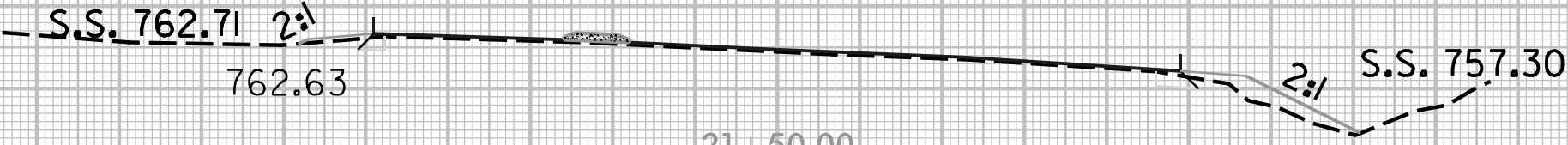

S.S. 762.71

762.63

21 + 50.00

2:1 S.S. 757.30

75 70 65 60 55 50 45 40 35 30 25 20 15 10 5 0 5 10 15 20 25 30 35 40 45 50 55 60 65 70 75

CUSTOMER'S PROPERTY  
NO PART OF THIS DRAWING  
TO BE REPRODUCED OR  
TRANSMITTED IN ANY  
FORM OR BY ANY MEANS  
ELECTRONIC OR MECHANICAL  
INCLUDING PHOTOCOPYING,  
RECORDING, OR BY ANY  
INFORMATION STORAGE  
RETRIEVAL SYSTEM  
WITHOUT PERMISSION  
IN WRITING FROM  
THE ENGINEER OF RECORD







75 70 65 60 55 50 45 40 35 30 25 20 15 10 5 0 5 10 15 20 25 30 35 40 45 50 55 60 65 70 75

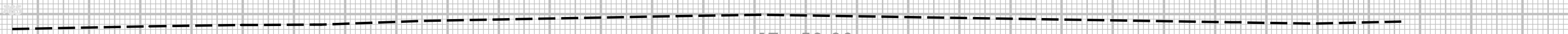

17+50.00

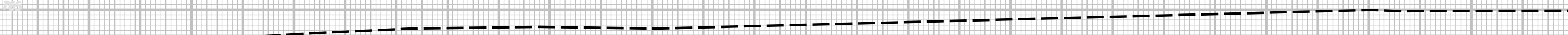

17+00.00

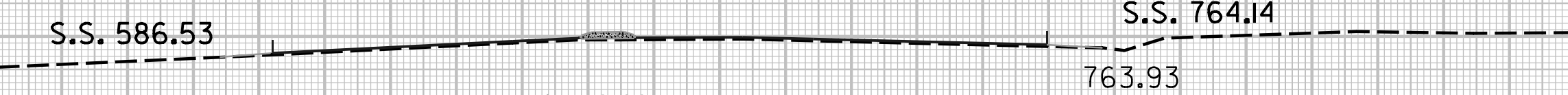

S.S. 586.53

S.S. 764.14

16+50.00

763.93

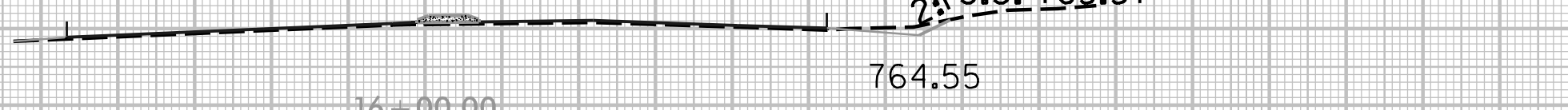

2:1 S.S. 765.57

16+00.00

764.55

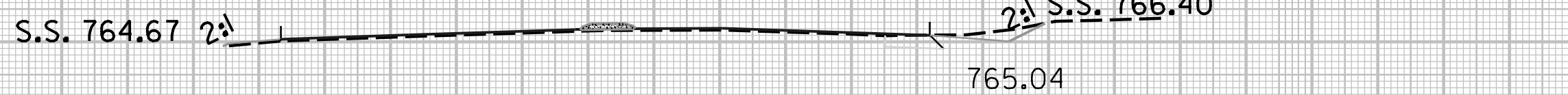

S.S. 764.67 2:1

2:1 S.S. 766.40

15+50.00

765.04

-X-

75 70 65 60 55 50 45 40 35 30 25 20 15 10 5 0 5 10 15 20 25 30 35 40 45 50 55 60 65 70 75

CUSTOMER'S PROPERTY  
NO PART OF THIS DRAWING  
TO BE REPRODUCED OR  
TRANSMITTED IN ANY  
FORM OR BY ANY MEANS  
ELECTRONIC OR MECHANICAL  
INCLUDING PHOTOCOPYING  
RECORDING OR BY ANY  
INFORMATION STORAGE  
RETRIEVAL SYSTEM  
WITHOUT PERMISSION  
IN WRITING FROM THE  
ENGINEER OF RECORD

75 70 65 60 55 50 45 40 35 30 25 20 15 10 5 0 5 10 15 20 25 30 35 40 45 50 55 60 65 70 75

S.S. 768.83

2:1

20+00.00

S.S. 767.67

2:1

19+50.00

767.44

S.S. 767.27

2:1/2:1

19+00.00

766.43

S.S. 765.81

18+50.00

S.S. 764.52

18+00.00

DATE: 8/23/99  
BY: [illegible]  
CHECKED: [illegible]  
SCALE: 1"=40'  
SHEET NO.: X-8  
PROJECT NO.: 50138-3-31

75 70 65 60 55 50 45 40 35 30 25 20 15 10 5 0 5 10 15 20 25 30 35 40 45 50 55 60 65 70 75

75 70 65 60 55 50 45 40 35 30 25 20 15 10 5 0 5 10 15 20 25 30 35 40 45 50 55 60 65 70 75

S.S. 773.10 2:1  
772.67

22+00.00

S.S. 771.98 2:1  
771.69

21+50.00

S.S. 770.73 2:1  
770.18

21+00.00

DRIVE

20+50.00

-X-

75 70 65 60 55 50 45 40 35 30 25 20 15 10 5 0 5 10 15 20 25 30 35 40 45 50 55 60 65 70 75

DATE: 8/23/99  
BY: [illegible]  
CHECKED: [illegible]  
SCALE: 1"=40'  
SHEET NO.: X-9  
PROJECT NO.: 50138-3-31